

±1°

Glass 16,76-21,52

Wedge and rubber set for glass ref. PL-14

Base shoe profile fascia-mount ref. SV-1404

Screed 30,0 N/mm<sup>2</sup>

Finished floor

FFL

Max. 1100

Max. 70

Min. 80

107

229

A

Uncracked concrete C25/30

Chemical anchor FIS VS 300 T, thread bar DIN 975 M10, washer DIN 125 M10 and nut DIN 934 M10 or similar

**KEY:**

	Glass
	Aluminium
	Nylon Polyamide
	PVC
	EPDM
	Concrete
	Mortar
	Finished floor

**Note:**  
PL-14 is a set of spacers, wedges and gaskets.

Finished floor level

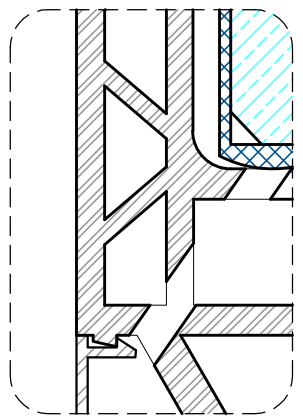

**Detail A. Drainage**  
Scale 1:4

Sheet cladding ref. PM-57

64

115

All dimensions are showed in millimeters (mm)

Due to the broad diversity of materials existing on the market and the different application methods outside of our control, we recommend in any case to do physical tests and sufficient controls to ensure the suitability of the product in each specific application. It is the responsibility of the user to establish the suitability of the information provided with their particular use of the product.

It is prohibited to make total or partial reproductions, as well as copies, without the written authorisation of Comenza.  
COPYRIGHT: COMENZA SL (2016)

Scale:	1:2	Format:	UNE A-3	System	GlassFit SV-1404 Side Y
Author:	Technical office			Model:	COMENZA_GlassFit SV-1404 Side Y_PM-57_Without handrail_R70_Q
Date:	01/09/2016			Plan:	General details
Customer:	N/A				
Project:	N/A				



Nº Plan  
1 / 1